

MODEL	DIMENSION								AXIAL LOAD		RADIAL LOAD		N.W
	INNER RING / d	OUTER RING / D	dp	WIDTH	La	na	Li	ni	Ca KN	Coa KN	Cr KN	Cor KN	Kg
XU050077	40	112	77	22	97	6-φ6.6	56	6-M8	22.4	29	14.3	14.2	1.4
XU060094	57	140	94	26	120	6-φ9	70	6-M8	32.5	37.5	20.7	18.4	2.4
XU060111	76.2	145.79	111	15.87	133.1	8-φ6.9	88.9	8-φ6.9	36	44.5	22.8	21.5	1.2
XU080120	69	170	120	30	148	6-φ9	90	6-M8	56	53	35.5	26	4
XU080149	101.6	196.85	149.6	22.22	177.8	16-φ6.9	115.8	16-φ6.9	63	66	40	32.5	3.6
XU120179	124.5	234	179	35	214	12-φ11	14.45	12-φ11	118	179	75	88	7
XU120222	140	300	222	36	270	12-M16	170	12-φ18	133	275	85	131	12
XU160260	191	329	260	46	305	20-φ14	215	20-φ14	212	350	135	173	16
XU080264	215.9	311	264	25.4	295.3	12-φ8.7	231.8	12-φ8.7	85	117	54	57	6.9
XU160405	336	474	405	46	450	30-φ14	360	30-φ14	270	550	172	270	25
XU080430	380	480	430	26	462	20-φ9	398	20-M10	110	280	70	138	12
XU300515	384	646	515	86	598	18-φ26	432	18-φ26	720	1370	455	670	115

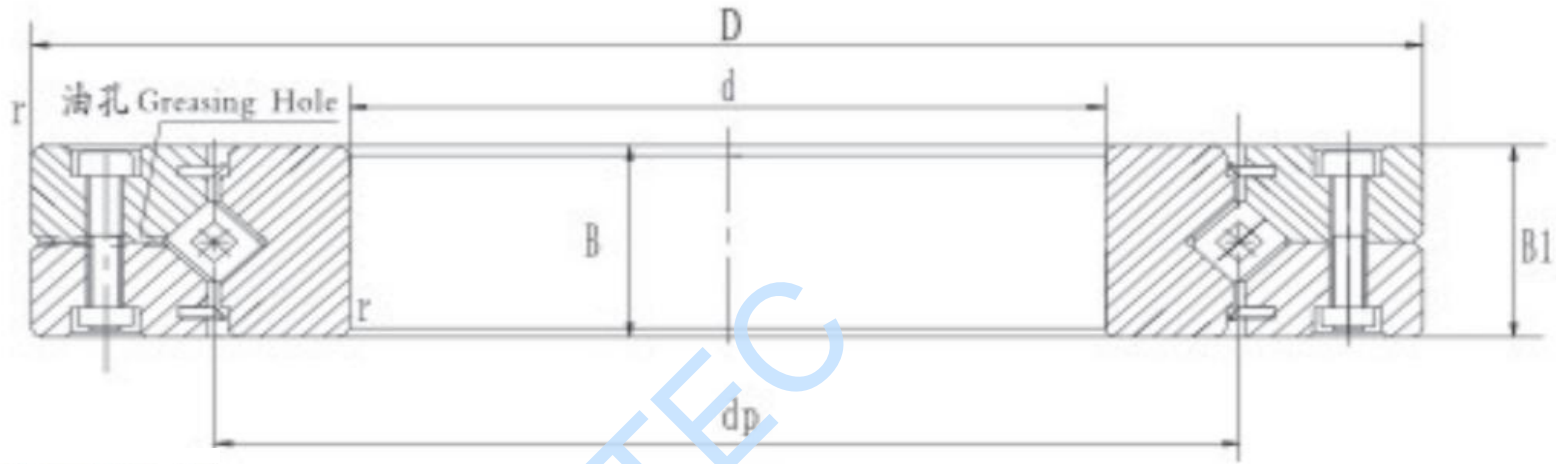

Shaft	MODEL		DIMENSION				Mounting dimensions		CRBC		CAB		N.W
	WITH CAGE	Full Complement	INNER RING d	OUTER RING D	WIDTH B	Chamfer	ds	Dh	Dynamic load rating C(KN)	Static load rating	Dynamic load rating C(KN)	Static load rating Co(KN)	Kg
40	CRBC 4010	CRB 4010	40	65	10	0.3	44	54	4.28	5.14	5.98	8.04	0.15
50	CRBC 5013	CRB 5013	50	80	13	0.6	55	71	10.7	12.6	14.2	18.4	0.29
60	CRBC 6013	CRB 6013	60	90	13	0.6	64	81	11.6	14.6	15.4	21.5	0.33
70	CRBC 7013	CRB 7013	70	100	13	0.6	75	91	12.3	16.7	17	25.5	0.38
80	CRBC 8016	CRB 8016	80	120	16	0.6	86	107	18.2	25.5	24.3	37.5	0.74
90	CRBC 9016	CRB 9016	90	130	16	1	98	118	19.4	28.6	25.9	42.1	0.81
100	CRBC10020	CRB 10020	100	150	20	1	108	134	31.5	45.1	39.4	61.1	1.45
110	CRBC11020	CRB 11020	110	160	20	1	118	144	33.5	50.7	41.2	66.7	1.56
120	CRBC12025	CRB 12025	120	180	25	1.5	132	164	47.7	70.5	59.9	95.4	2.62
130	CRBC13025	CAB 13025	130	190	25	1.5	140	172	49.2	74.8	61	99.8	2.82
140	CRBC14025	CRB 14025	140	200	25	1.5	151	183	50.7	79.2	64.1	108	2.96

150	CRBC15025	CRB 15025	150	210	25	1.5	160	192	53.8	87.7	65	113	3.16
	CRBC15030	CRB 15030	150	230	30	1.5	166	202	69.2	108	85.9	144	5.3
200	CRBC20025	CAB 20025	200	260	25	2	208	239	60.2	110	75.3	148	4
	CRBC20030	CRB 20030	200	280	30	2	218	262	108	178	133	234	6.7
	CRBC20035	CRB 20035	200	295	35	2	221	274	137	215	168	282	9.58
250	CRBC25025	CRB 25025	250	310	25	2.5	259	290	67.2	136	83.9	183	4.97
	CRBC25030	CRB 25030	250	330	30	2.5	265	310	116	208	146	283	8.1
	CRBC25040	CRB 25040	250	355	40	2.5	271	330	179	299	215	382	14.8
300	CRBC30025	CRB 30025	300	360	25	2.5	310	341	74	162	91.9	217	5.88
	CRBC30035	CRB 30035	300	395	35	2.5	318	372	163	299	205	408	13.4
	CRBC30040	CRB 30040	300	405	40	2.5	321	381	194	351	235	451	17.2
400	CRBC40035	CRB 40035	400	480	35	2.5	414	457	133	300	165	400	14.5
	CRBC40040	CRB 40040	400	510	40	2.5	423	483	222	455	270	590	23.5
	CRBC40070	CRB 40070	400	580	70	2.5	430	532	470	811	576	1060	72.4
500	CRBC50040	CRB 50040	500	600	40	2.5	517	573	211	497	259	648	26
	CRBC50050	CRB 50050	500	625	50	2.5	531	592	247	561	306	747	41.7
	CRBC50070	CRB 50070	500	680	70	2.5	530	633	536	1020	653	1330	86.1
600	CRBC60040	CRB 60040	600	700	40	3	621	676	231	581	287	774	30.6
	CRBC60070	CRB 60070	600	780	70	3	630	734	591	1230	700	1540	102
	CRBC600120	CRB 600120	600	870	120	3	643	817	1250	2210	1490	2800	274
700	CRBC70045	CRB 70045	700	815	45	3	730	785	250	681	301	917	46.5
	CRBC70070	CRB 70070	700	880	70	3	731	834	630	1390	766	1810	115
	CRBC700150	CRB 700150	700	1020	150	3	751	953	1660	3010	1980	3820	478
800	CRBC80070	CRB 80070	800	950	70	4	831	907	417	1090	513	1440	109
	CRBC800100	CRB 800100	800	1030	100	4	840	972	936	2040	1140	2640	247

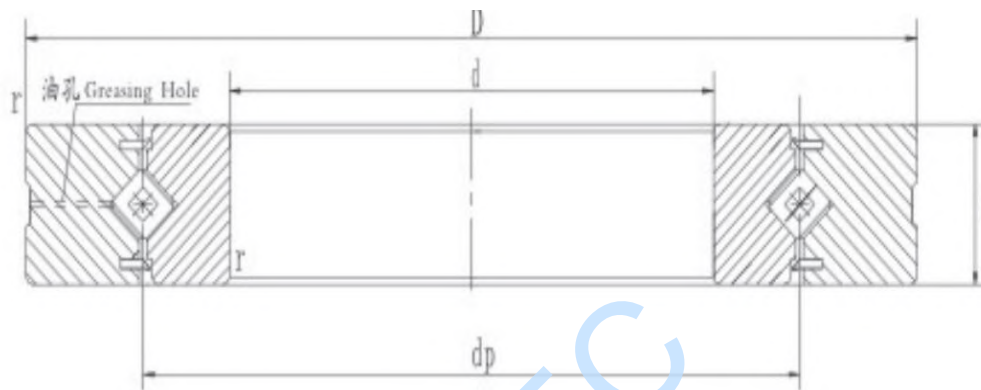

SHAFT DIA.mm	MODEL		MAIN DIMENSIONS				HEIGHT		RADIAL LOAD		N.W
			INNER RING/d	OUTER RING/D	WIDTH B/B1	CHAMFER/r	da	Da	C / KN	Co / KN	Kg
50	CRBH 5013A	CRBH 5013AUU	50	80	13	0.6	56	74	17.3	20.9	0.29
60	CRBH 6013A	CRBH 6013AUU	60	90	13	0.6	66	84	18.8	24.3	0.33
70	CRBH 7013A	CRBH 7013AUU	70	100	13	0.6	76	94	20.1	27.7	0.38
80	CRBH 8016A	CRBH 8016AUU	80	120	16	0.6	88	112	32.1	43.4	0.74
90	CRBH 9016A	CRBH 9016AUU	90	130	16	0.6	98	122	33.1	46.8	0.81
100	CRBH 10020A	CRBH 10020AUU	100	150	20	0.6	110	140	50.9	72.2	1.45
110	CRBH 11020A	CRBH 11020AUU	110	160	20	0.6	120	150	52.4	77.4	1.56
120	CRBH 12025A	CRBH 12025AUU	120	180	25	1	132	168	73.4	108	2.62
130	CRBH 13025A	CRBH 13025AUU	130	190	25	1	142	178	75.9	115	2.82
140	CRBH 14025A	CRBH 14025AUU	140	200	25	1	152	188	81.9	130	2.96
150	CRBH 15025A	CRBH 15025AUU	150	210	25	1	162	198	84.3	138	3.16
200	CRBH 20025A	CRBH 20025AUU	200	260	25	1	212	248	92.3	169	4
250	CRBH 25025A	CRBH 25025AUU	250	310	25	1.5	262	298	102	207	4.97

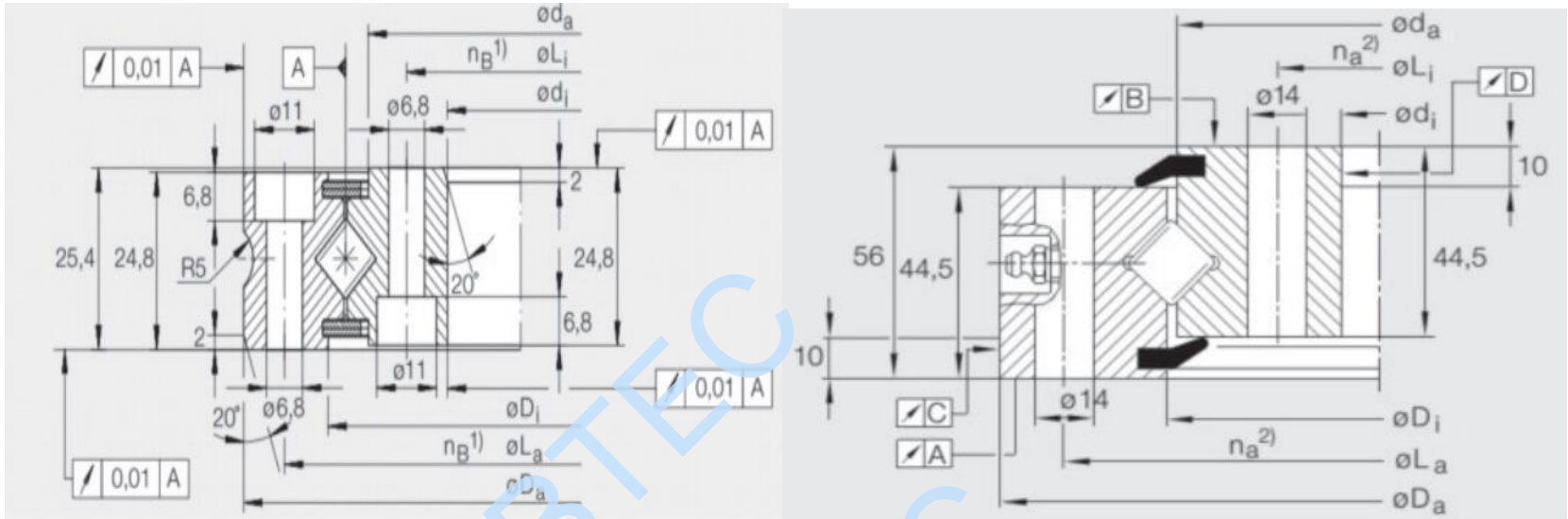

SHAFT	MODEL	DIMENSION							AXIAL LOAD		RADIAL LOAD		LIMIT SPEED	N.W
		INNER RING/d	OUTER RING/D	WIDTN	Nb	CHAMFER	La	Li	Ca KN	Coa KN	Cr KN	Cor KN	R/MIN	Kg
130	XSU080168	130	205	25.4	12	1.1	190	145	66	240	42	96	227	3.3
150	XSU080188	150	225	25.4	16	1.1	210	165	71	275	46	110	203	3.7
180	XSU080218	180	255	25.4	20	1.1	240	195	77	315	49	127	175	4.3
220	XSU080258	220	295	25.4	24	1.5	280	235	84	375	54	151	148	5.1
280	XSU080318	280	355	25.4	28	1.5	340	295	93	465	59	185	120	6.3
360	XSU080398	360	435	25.4	36	2	420	375	106	590	68	236	96	7.8
344	XSU140414	344	484	56	24	2	460	368	229	520	146	250	/	28
474	XSU140544	474	614	56	32	2.5	590	498	270	680	170	330	/	38
574	XSU140644	574	714	56	36	2.5	690	598	290	800	185	395	/	44
674	XSU140744	674	814	56	40	3	790	698	315	930	200	455	/	52
774	XSU140844	774	914	56	40	3	890	798	340	1050	215	510	/	60
874	XSU140944	874	1014	56	44	3	990	898	360	1170	227	580	/	67

RU...X
(CRBF...AT)

RU...G
(CRBF...AD)

RU
(CRBF...A)

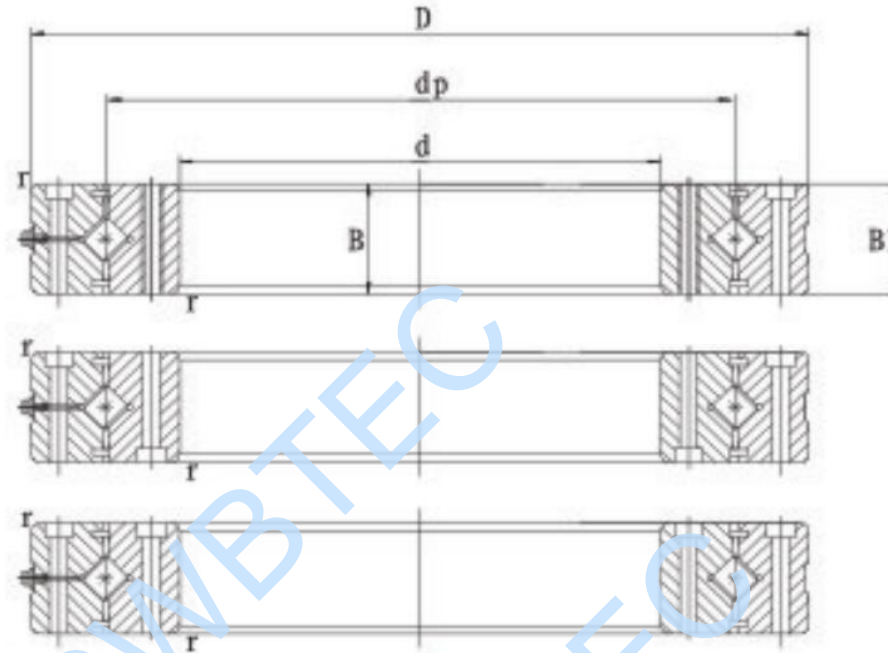

SHAFT DIA. mm	MODEL		MAIN DIMENSIONS					HEIGHT		RADIAL LOAD		N. W
	THK	IKO	INNER RING/d	OUTER RING/D	dp	WIDTH B/B1	CHAMFER/r	ds	Dh	C / KN	Co / KN	Kg
80	RU124/RU124G	CRBF8022AD CRBF8022A	80	165	124	22	1	114	134	33.1	50.9	2.6
	RU124X	CRBF8022AT										
90	RU148/RU148G	/	90	210	147.5	25	1.5	133	162	49.1	76.8	4.9
	RU148X											
115	RU178/RU178G	/	115	240	178	28	1.5	161	195	80.3	135	6.8
	RU178X											
160	RU228/RU228G	/	160	295	227.5	35	2	208	246	104	172	11.4
	RU228X											
210	RU297/RU297G	/	210	380	297.3	40	2.5	272	320	156	281	21.3
	RU297X											
350	RU445/RU445G	/	350	540	445.4	45	2.5	417	473	222	473	35.4
	RU445X											

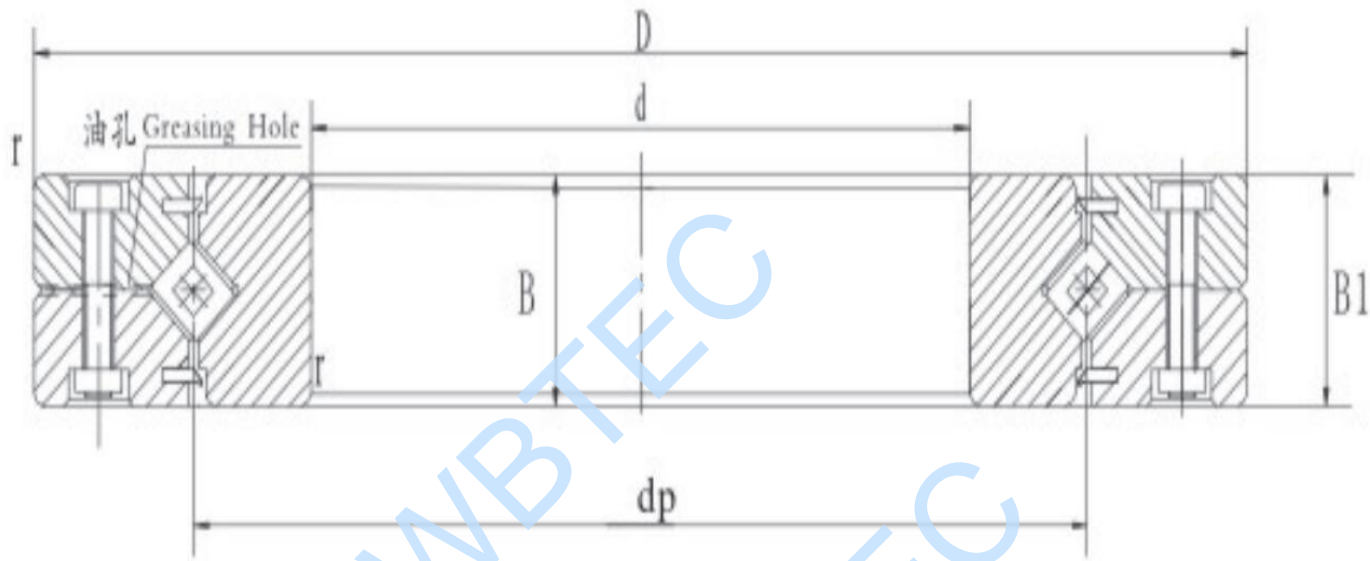

SHAFT DIA. mm	MODEL	MAIN DIMENSIONS						HEIGHT		RADIAL LOAD		N. W
		INNER RING/d	OUTER RING/D	dp	WIDTH B/B1	GREASE HOLE	CHAMFER/r	ds	Dh	C / KN	Co / KN	Kg
80	RB8016	80	120	98	16	1.5	1.5	98	118	31.4	45.3	0.7
90	RB9016	90	130	108	16	1.5	1.5	98	118	1.4	45.3	0.75
100	RB10016	100	140	119.3	16	1.5	1.5	109	129	31.7	448.6	0.83
	RB10020		150	123	20	1.5	1.5	113	133	33.1	50.9	1.45
110	RB11012	110	135	121.8	12	1.5	1	117	127	12.5	24.1	0.4
	RB11015		145	126.5	15	1.5	1	122	136	23.7	41.5	0.75
	RB11020		160	133	20	1.5	1.5	120	142	34	54	1.56
168	RB12016	120	150	134.2	16	1.5	1.5	127	141	24.2	43.2	0.72
	RB12025		180	148.7	25	2	1	133	164	66.9	100	2.62
130	RB13015	130	160	144.5	15	1.5	2	137	152	25	46.7	0.72
	RB13025		190	158	25	2	1	143	174	69.5	107	2.82
140	RB14016	140	175	154.8	16	1.5	2	147	162	25.9	50.1	1
	RB14025		200	168	25	2	1.5	154	185	74.8	121	2.96

150	RB15013	150	180	164	13	1.5	2	157	172	27	53.5	0.68
	RB15025		210	178	25	2	1	164	194	76.8	128	3.16
	RB15030		230	188	30	3	2	173	211	100	156	5.3
160	RB16025	160	220	188.6	25	2	2	173	204	81.7	135	3.14
170	RB17020	170	220	191	20	1.5	2	184	198	29	62.1	2.11
180	RB18025	180	240	210	25	2	2	195	225	84	143	3.44
190	RB19025	190	240	211.9	25	1.5	2	202	222	41.7	82.9	2.99
200	RB20025	200	260	230	25	2	2.5	215	245	84.2	157	4
	RB20030		280	240	30	3	2.5	221	258	114	200	6.7
	RB20035		295	247.7	35	3	2.5	225	270	151	252	9.6
220	RB22025	220	280	250.1	25	2	2.5	235	265	92.3	171	4.1
240	RB24025	240	300	269	25	2	3	256	281	68.3	145	4.5
250	RB25025	250	310	277.5	25	2	3	265	290	69.3	150	5
	RB25030		330	287.5	30	3	3	269	306	126	244	8.1
	RB25040		355	300.7	40	3.5	3	275	326	195	348	14.8
300	RB30025	300	360	325	25	2	3	315	340	76.3	178	5.9
	RB30035		395	345	35	3	3	322	368	183	367	13.4
	RB30040		405	351.6	40	3.5	3	326	377	212	409	17.2
350	RB35020	350	400	373.4	20	1.5	3.5	363	383	54.1	143	3.9
400	RB40035	400	480	410.3	35	3	3.5	422	459	156	370	14.5
	RB40040		510	453.4	40	3.5	1.5	428	479	241	531	23.5
450	RB45025	450	500	474	25	1.5	1.5	464	484	61.7	182	6.6
500	RB50025	500	550	524.2	25	1.5	1.5	514	534	65.5	201	7.3
	RB50040		600	548.8	40	3	3.5	526	572	239	607	26
	RB50050		625	561.6	50	3.5	3.5	536	587	267	653	41.7
600	RB60040	600	700	650	40	3	4	627	673	264	721	29
700	RB70045	700	815	753.5	45	3	4	731	777	281	836	46
800	RB80070	800	950	868.1	70	4	5	836	900	468	1330	105
900	RB90070	900	1050	969	70	4	5	937	1001	494	1490	120
1000	RB1000110	1000	1250	1114	110	6	6	1057	1171	1220	3220	360
1250	RB1250110	1250	1500	1365.8	110	6	6	1308	1423	1350	3970	440